



2024 City Of Portage Urban Deer Application

Application Year

DNR Custom ID #

"Where the North Begins"

Applicant: First Middle Last Name

Applicant Phone Number

Address: _____

Applicant email address: _____

Proficiency Test:	<input type="checkbox"/>	Pass (office use only)	<input type="checkbox"/>
Proof of valid Archery License:	<input type="checkbox"/>		
Copy of Photo Id:	<input type="checkbox"/>	\$5.00 fee paid (to city):	<input type="checkbox"/>
Applicants Birthday (MM/DD/YY): _____			

A person exercising privileges granted pursuant to the city's Urban Deer hunt shall thereby voluntarily assume full responsibility for any risks of loss, property damage or personal injury, including death, caused or incurred by the Permittee and shall indemnify and hold the City of Portage harmless for any such claims. If the Permittee is exercising privileges granted pursuant to a hunting permit on land which is owned or controlled, in whole or part, by the City of Portage shall, without need for further evidence or assent, be deemed to have released, waived, discharged and to have covenanted not to sue the City for loss, damage, or injury, including death, that may be sustained, whether caused by negligence of the City, the condition of the property, or otherwise, while participating in such activities.

I hereby state that I understand the rules and regulations set forth within the DNR and City of Portage Urban Deer Hunt. Failure to comply with said State and local regulations may cause revocation of my permits in said deer hunts and may include fines per ordinance Sec. 46—31.

Signature

Zone/Time Information (Please indicate zone preference and circle date wanted)

Limit 3 weeks per person. Hunters can set up on the first day and leave tree stands in their zone during their week (s). All stands must be removed on the last day of your week.

2024 Hunting Season Dates

- | | | | |
|---------------|--------------------------|---------------------------|---------------------------|
| Zone 1 | <input type="checkbox"/> | 1. September 14-20 | 9. November 9-15 |
| Zone 2 | <input type="checkbox"/> | 2. September 21-27 | 10. November 16-22 |
| Zone 3 | <input type="checkbox"/> | 3. September 28-Oct 4 | (gun season break) |
| Zone 4 | <input type="checkbox"/> | 4. October 5-11 | 11. December 7-13 |
| | | 5. October 12-18 | 12. December 14-20 |
| | | 6. October 19-25 | 13. December 21-27 |
| | | 7. October 26- November 1 | 14. December 28-January 3 |
| | | 8. November 2-8 | |

Permit Information

(office only)

Permit #: _____

Season Date: _____

Date Issued: _____

Receipt #: _____

Code: 1215

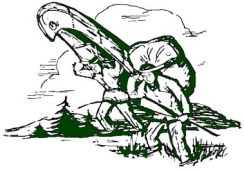

City of Portage Archery Proficiency Score Sheet

"Where the North Begins"

_____ (year)

_____ DNR Customer #

Full Name: _____

Address: _____

City: _____

State: _____

Zip: _____

1st 2nd 3rd 4th 5th 6th

PASS

FAIL

Scorer's Name: _____ Date: _____

Scorer's Signature: _____

Scoring will be by personnel assigned by the Archery establishment. Note that said personnel have the right to deny the applicant access to the range for testing. Equipment brought to testing must be deemed legal for hunting under DNR regulations and/or rules within City of Portage Ordinance 46—31. If warm-ups are used, it is up to the shooter to contact a scorer to start the process of accumulating scores. Scorer will track arrows accordingly above. A minimum of 5 out of 6 arrows placed within the target is a Pass grade.

*Applicant must return this completed form to City Hall in order to complete Application. A Pass Grade is good for 5 consecutive seasons.

All proficiency tests will be performed at:

D W Sports Center, 125 Cook Street, Portage, WI 53901

(608) 742 - 7745

There will be an additional \$5.00 fee payable to D W Sport center which will allow two chances for applicant to qualify. If applicant fails twice, applicant will need to pay an additional \$5.00 for two additional chances. Only 1 test per day, per applicant is allowed.

Hunters Performance

Year: _____ DNR #: _____ Name: _____ Address: _____ Phone: _____ Email: _____	City of Portage—Harvest Report Zone #: _____ Season Dates: _____
LOG TOTALS # of Shots Taken: _____ # of Deer Hit: _____ # of Arrows Retrieved: _____ # of Deer Recovered: _____	OBSERVATION TOTALS # days hunted: _____ # of deer seen: _____ # of hunters seen: _____ # of non-hunters: _____
Animals Lost (if applicable) Game tracked to land not accessible <input type="checkbox"/> Lost Blood Trail <input type="checkbox"/> Other: <input type="checkbox"/>	I Certify that the above information is true and correct: _____ <p style="text-align: center;"><i>Signature</i></p>
Total Time Spent Searching (hours): _____	Date Returned: _____ Initials: _____ Permit holder must return this report to Portage Park and Recreation Department within 72 hours of season end. Failure to do so will cause loss of privileges as stated in ordi-

ORDINANCE NO. 14-008 and 14-014

ORDINANCE RELATIVE TO OFFENSES AGAINST PUBLIC SAFETY AND PEACE (BOW HUNTING)

The Common Council for the City of Portage does hereby Ordain as follows:

The following Sections are hereby repealed and recreated to read as follows:

Sec. 46-31. Regulation of firearms, weapons and explosives.

(a) *Discharge and possession of firearms and weapons regulated.* No person, except a police officer or other law enforcement officer in the performance of an official duty, or a person working for a firm designated by the common council to harvest wildlife pursuant to a state department of natural resources approved wildlife management program, shall fire or discharge any firearm, rifle, spring gun, air gun or pneumatic pellet gun of any description, crossbow or bow and arrow (except as provided in Sec. 46-31(e)), within the city or have any firearm, rifle, spring gun, air gun or pneumatic pellet gun in his possession or under his control except as permitted by state law. Except as provided in Sec. 46-31(e), this subsection shall be deemed to prohibit hunting within the corporate limits of the city. This provision does not apply to persons authorized by firms hired by the city to conduct wildlife harvest pursuant to state department of natural resources approved wildlife management programs.

(e) *Regulation of Hunting Within City Limits.* The general prohibition against hunting within City of Portage corporate limits is exempted according to the rules and regulations set out below:

- (1) Deer hunting by archery is permissible within the corporate limits during annual Wisconsin DNR designated archery hunting seasons under the following conditions:
 - a. Hunting of deer by archery within the corporate limits shall be done in accordance with the rules and regulations of the Wisconsin Department of Natural Resources, and city ordinances.
 - b. Hunters must possess current Wisconsin DNR archery license.
 - c. No release of a hunting arrow or bolt may occur within 300 feet from a park or building located on another person's land, unless the hunter has permission from the landowner to hunt within the 300 feet.
 - d. Any hunter releasing a hunting arrow or bolt is required to discharge the hunting arrow or bolt toward the ground, from an elevated stand or other means. The arrow or bolt shall have the owner's name and telephone number permanently affixed.
 - e. Hunters must have permission of any landowner before tracking or retrieving deer from the landowner's property.
- (2) *Deer hunting by archery within the corporate limits on designated city-owned property in the City of Portage shall be permitted upon obtaining a municipal hunting permit issued by the Portage Parks and Recreation Department or other designated agent subject to the requirements as listed under Sec. 46-31(e)(1) and the following:*

- a. Hunting shall only be allowed on municipal property(ies) as shown on a map approved by the Legislative and Regulatory Committee. The map shall be retained and reviewed annually by the Portage Parks and Recreation and Police Department.
 - b. Prior to receipt of a municipal hunting permit, every applicant for such permit must complete an application at the Portage Parks and Recreation Department providing their name, address, phone number, photo identification, indicate desired municipal property they wish to hunt, provide proof of possession of a DNR archery hunting license and show proof of successful completion of marksmanship proficiency certification. The City of Portage Common Council shall include the cost of the municipal hunting permit on the official Fee Schedule. The permit shall expire at the end of each calendar year or at such time as determined.
 - c. Elevated stands and/or ground blinds may be installed on municipal property no earlier than 24 hours prior to a permitted hunt and shall be removed by the end of allowable hunting hours on the last day of the permitted hunt. Said stands or blinds shall have the owner's name, address and phone number attached that is visible from the ground. Tree stands, or tree steps shall not be permanently installed or attached to trees in such a manner that damages the tree. Cutting of shooting lanes shall not be permitted.
 - d. Hunters shall at minimum, wear a blaze orange cap while hunting.
 - e. Coordinated drives for the purpose of hunting deer are not permitted.
 - f. Each municipal hunting permit shall designate the dates and times it is valid. Such dates and times shall be given to each person applying for a municipal hunting permit. Hunters shall complete and return the hunter performance section of the municipal hunting permit to the Parks and Recreation office within 72 hours of final day of permitted hunting. Failure to return hunter performance section of municipal hunting permit shall result in suspension of eligibility to receive future municipal hunting permits.
- (3) No motorized vehicles are permitted on municipal property except for authorized City vehicles.
- (4) Fish may be hunted by archery within the corporate limits of the city in bodies of water designated by the City of Portage Legislative and Regulatory Committee. Hunting of fish by archery shall be done in accordance with the rules and regulations of the Wisconsin Department of Natural Resources, and the city ordinances. In no circumstances shall fishing be allowed from vehicular or pedestrian bridges or within 75' of public boat landings or within 75' of the boundaries of the public beach on Silver Lake during the hours the beach is open.
- (5) Penalty. Any person violating any provision of this section shall be subject to the general penalty provisions of Sec. 1-15.

Sec. 46-33. Throwing or shooting of arrows, stones and other missiles prohibited.

Except as provided in Sec. 46-31(e), it shall be unlawful for any person to discharge or throw by any means any dangerous missile, object, arrow, stone, snowball or other missile within the city.





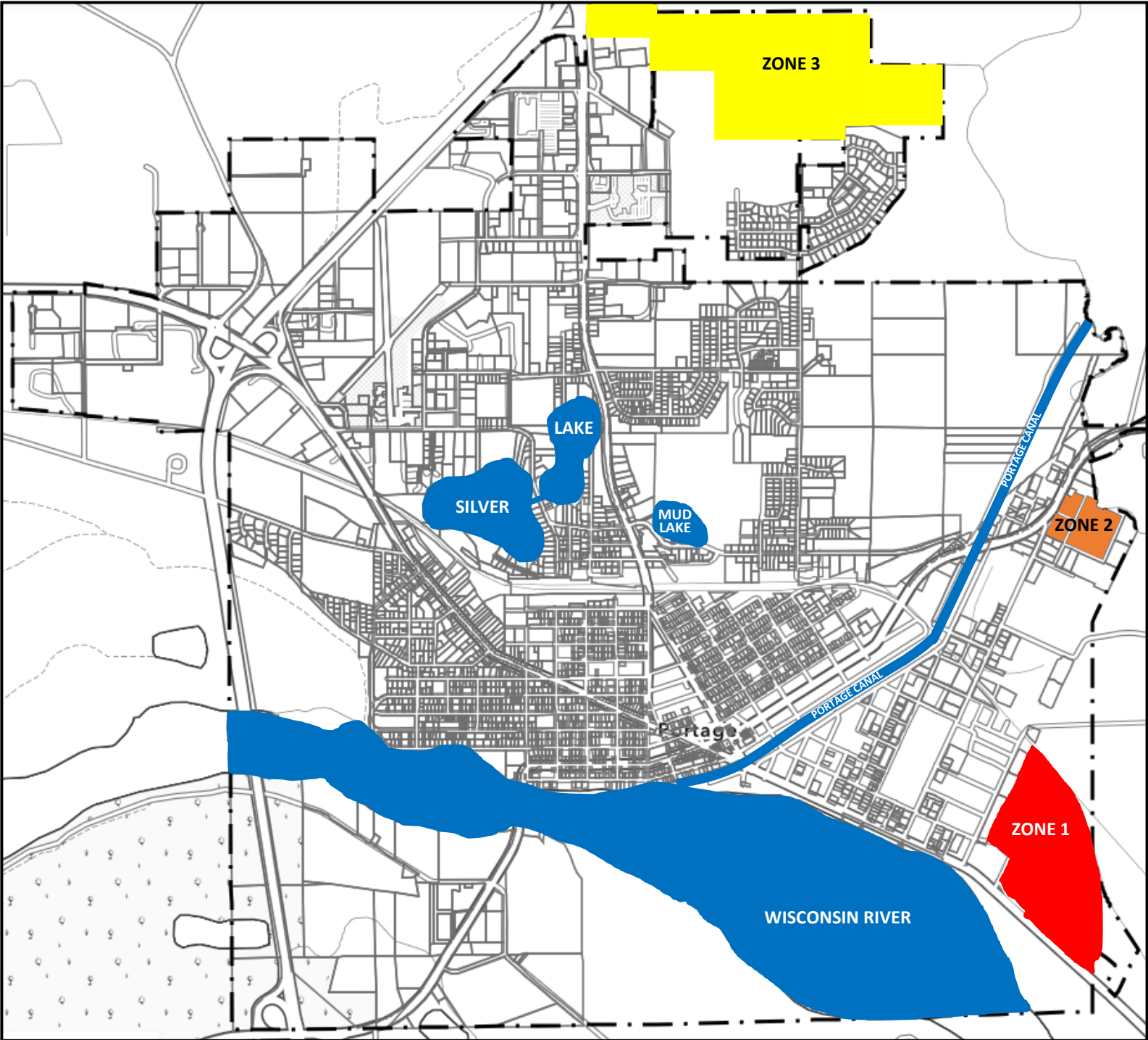

This Ordinance shall take effect upon passage and publication thereof.

City of Portage — 2024 Urban Bow Hunting and Fishing Map



CITY OF PORTAGE

'Where the North Begins'

	ZONE 1 (64.95 ACRES) PARCEL 2581.03
	ZONE 2 (20.27 ACRES) PARCELS 46, 93.01, 95
	ZONE 3 (232.27 ACRES) PARCELS 5000.01, 5000.02
	BOW FISHING RIVER, CANAL, LAKES AS SHOWN
	CITY LIMITS
	CITY TAX PARCELS

* A MORE DETAILED MAP WILL BE ISSUED WITH THE PURCHASE OF A LICENSE. (AVAILABLE AT PORTAGE CITY HALL)



9/3/2024, 4:12:09 PM

 City Limits

 City Tax Parcels

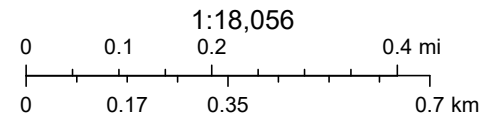

Esri Community Maps Contributors, Esri, TomTom, Garmin, SafeGraph, GeoTechnologies, Inc, METI/NASA, USGS, EPA, NPS, US Census Bureau,

Urban Deer Map/Bow Hunting Locations

9/4/2024

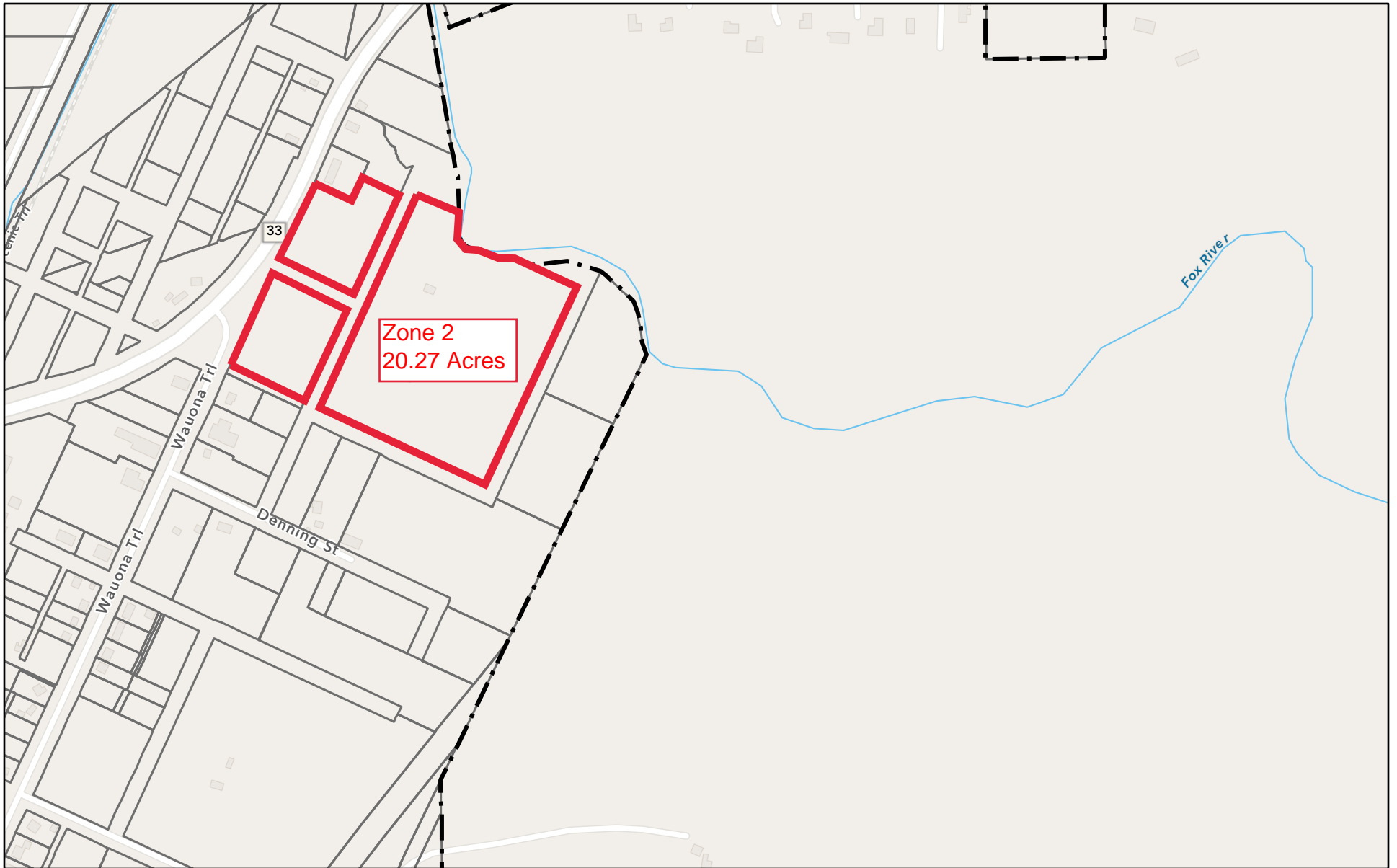

9/3/2024, 4:13:32 PM

 City Limits

 City Tax Parcels

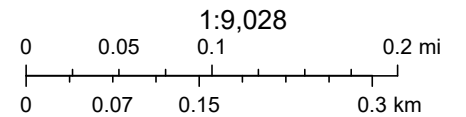



Esri Community Maps Contributors, © OpenStreetMap, Microsoft, Esri, TomTom, Garmin, SafeGraph, GeoTechnologies, Inc, METI/NASA, USGS,

Urban Deer Map/Bow Hunting Locations

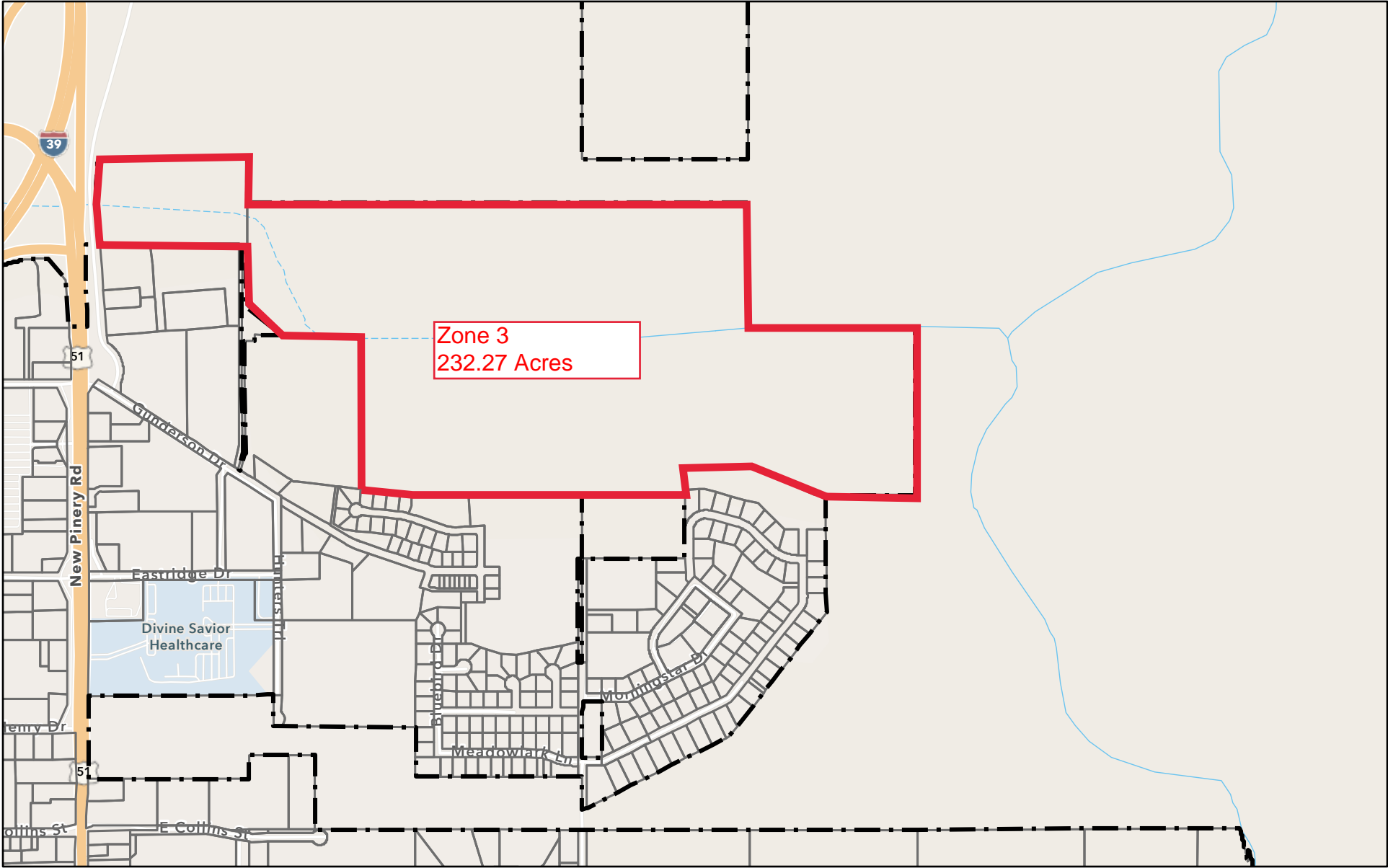
9/4/2024



9/3/2024, 4:07:13 PM

-  City Limits
-  City Tax Parcels

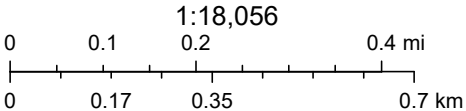

Esri Community Maps Contributors, Esri, TomTom, Garmin, SafeGraph, GeoTechnologies, Inc, METI/NASA, USGS, EPA, NPS, US Census Bureau,